

SILENT

LINE: PERSONAL

HIGH/LOW PRESSURE COMPRESSOR

Catalogue

2019



BAR **CÓNTRÒL** TECHNOLOGY

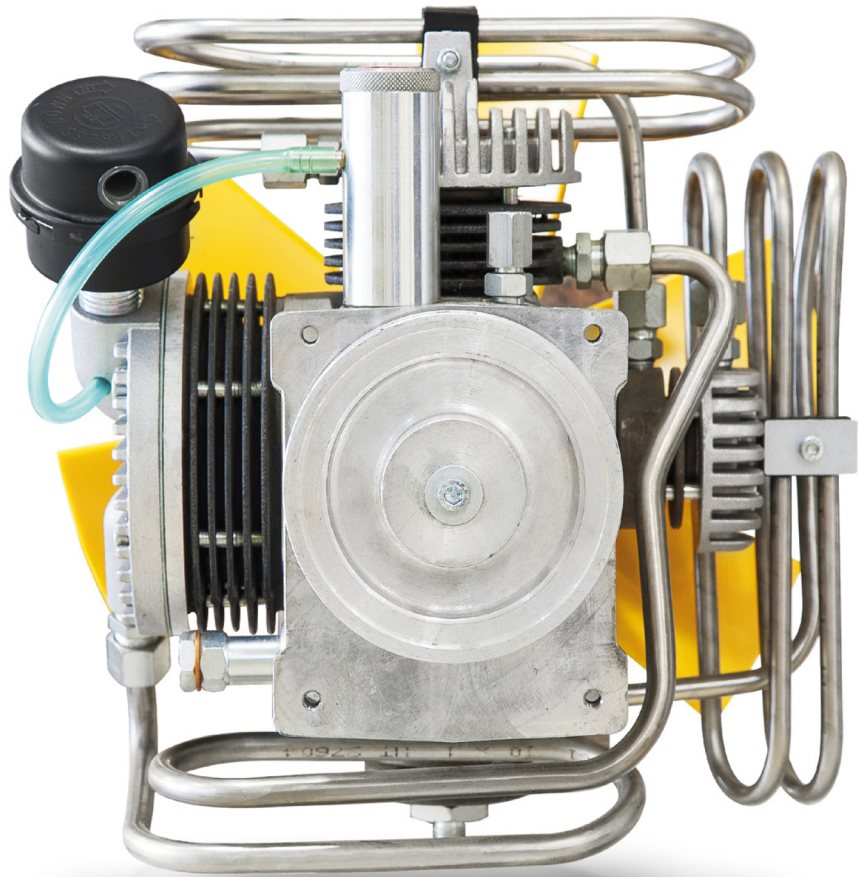

SPARE PARTS LIST

Indice - Index

Flange - Cooling fan

Crankshaft

1st Stage

2nd Stage

3rd Stage

4th Stage

Pressure Circuit

Gaskets pumping group



FLANGE/COOLING FAN

Pos.	Q.ty	Code	Description
KIT1	1	6-00-019/R	COOLING FAN KIT
1.1	1		COOLING FAN
1.2	1		COOLING FAN FLANGE
1.3	1		COUNTER-WEIGHT
1.4	3		SCREW T.C.E. ZINC. 6X30 DIN 912
1.5	1		WASHER 6,5x18x2 FLAT ZINC
1.6	5		WASHER 6.5X12.5X1.5 ZINC
1.7	2		SCREW T.C.E. ZINC. 6X20 DIN 912
1.8	1		KEY
1.9	1		SCREW T.C.E. ZINC. 6x30 DIN 912
KIT2	1	6-00-009/R	LARGE FLANGE KIT
2.1	1		LARGE FLANGE
2.2	1		BEARING 6302
2.3	1		OIL SEAL 14X35X7
2.4	1		O-RING 2300 NBR 90SH
2.5	4		SCREW TCE 6X16
KIT3	1	6-00-008/R	SMALL FLANGE KIT
3.1	1		SMALL FLANGE
3.2	1		BEARING 6302
3.3	1		OIL SEAL 15X35X7
3.4	1		O-RING 2250 NBR 90SH
3.5	4		SCREW TCE 6X16
KIT4	1	6-00-023/R	100MM PULLEY KIT
4.1	1		PULLEY DIAM.100
4.2	1		SCREW TCE 6X16
4.3	1		WASHER 6X18X1.5 FLAT ZINC
4.4	1		KEY
KIT5	1	6-00-028/R	KIT OIL DRAIN PLUG
5.1	1	6-00-028	OIL DRAIN PLUG
5.2	1	GUAR1319	OIL DRAIN COPPER GASKET
6	1	6-00-014/R	OIL DIPSTICK

FLANGE/COOLING FAN

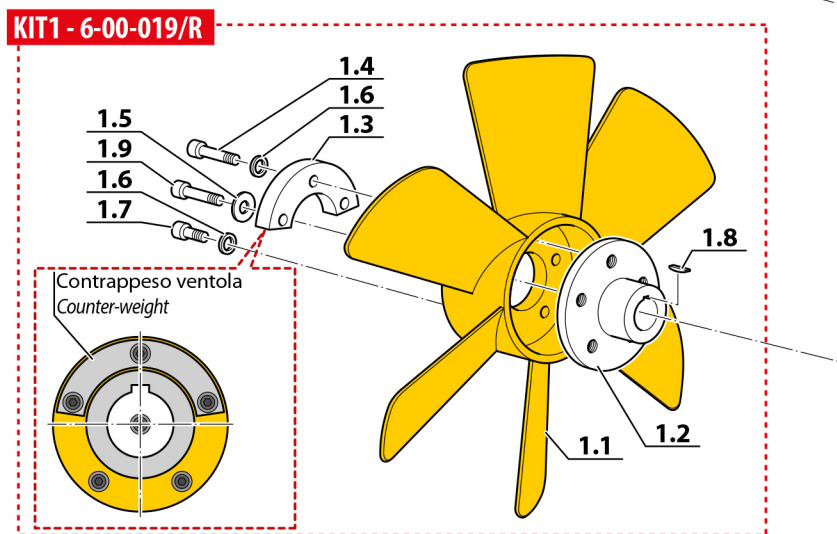
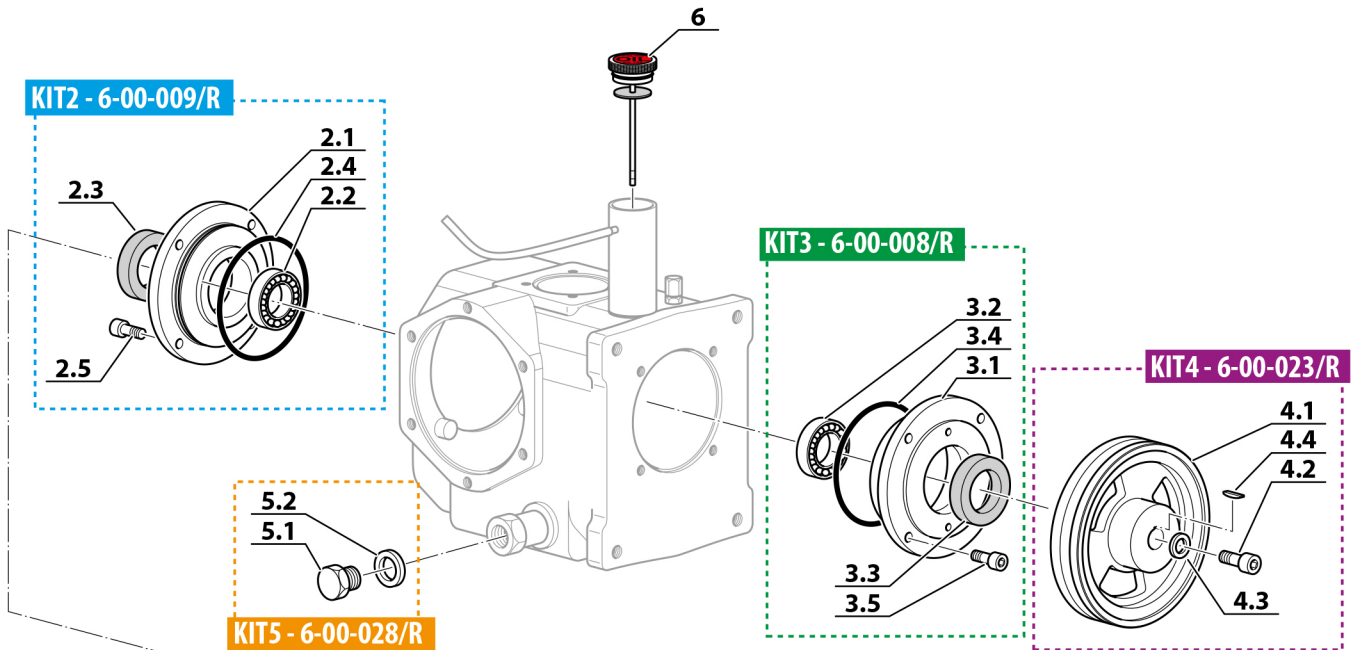

CRANKSHAFT

Pos.	Q.ty	Code	Description
KIT1	1	6-01-005/R	1ST STAGE CONNECTING ROD KIT
1.1	1		CONNECTING ROD 1ST STAGE
1.2	1		BRONZE BUSH A 12-15-12
1.3	1		BEARING SCE 188
KIT2	1	6-02-005/R	2ND STAGE CONNECTING ROD KIT
2.1	1		CONNECTING ROD 2ND STAGE
2.2	1		BRONZE BUSH A 12-15-12
2.3	1		BEARING SCE 188
KIT3	1	6-03-005/R	3RD STAGE CONNECTING ROD KIT
3.1	1		CONNECTING ROD 3RD STAGE
3.2	1		BRONZE BUSH A 7-10-10
3.3	1		BEARING SCE 188
KIT4	1	6-04-005/R	4TH STAGE CONNECTING ROD KIT
4.1	1		CONNECTING ROD 4TH STAGE
4.2	1		BRONZE BUSH A 7-10-10
4.3	1		BEARING SCE 188
KIT5	1	6-00-003/R	CRANKSHAFT KIT
5.1	1		BEARING 6302
5.2	1		LONG SPACER
5.3	1		CRANKSHAFT
5.4	2		KEY

CRANKSHAFT

Direction of assembly of 3rd and 4th stage connecting rods

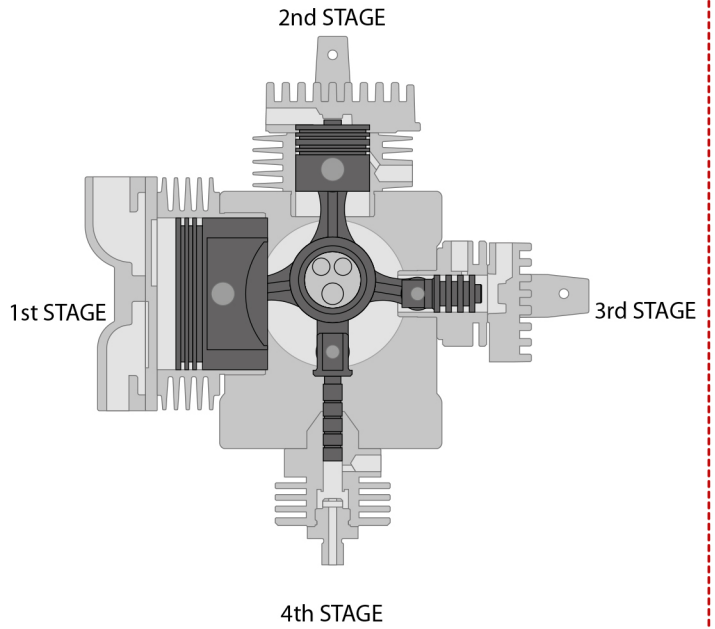
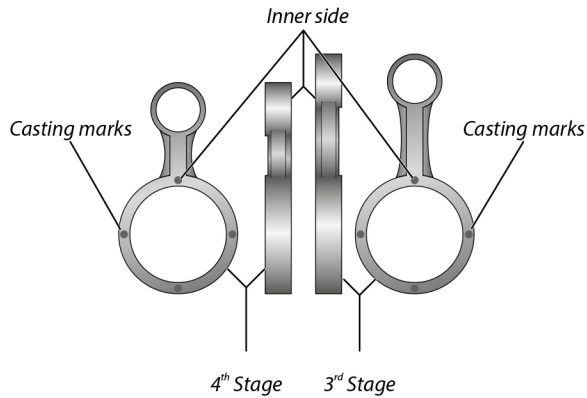

KIT4 - 6-04-005/R

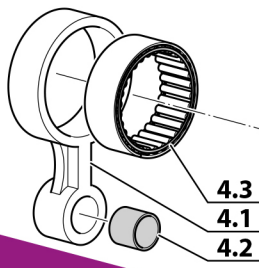

4th STAGE

KIT3 - 6-03-005/R

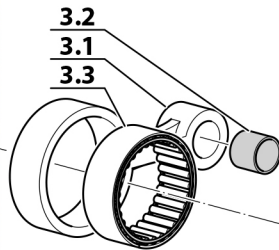

3rd STAGE

KIT1 - 6-01-005/R

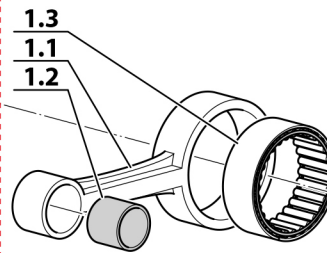

1st STAGE

KIT2 - 6-02-005/R

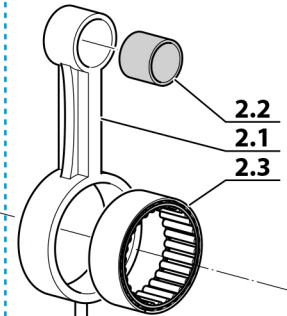

2nd STAGE

KIT5 - 6-00-003/R

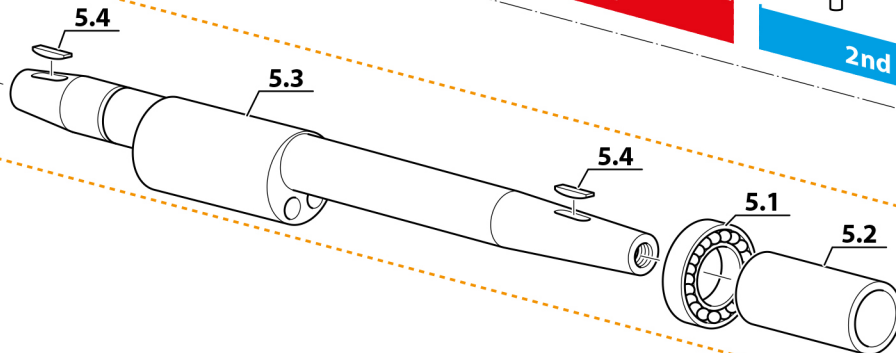

1ST STAGE

Pos.	Q.ty	Code	Description
KIT1	1	6-01-015/R	1ST STAGE CYLINDER HEAD COVER KIT
1.1	1		CYLINDER HEAD COVER 1ST STAGE
1.2	1		CONNECTION 1/4NPT - 10MM TUBE
1.3	1		CYLINDER HEAD COVER GASKET
1.4	5		SCREW TCE 6X60
1.5	1		SCREW TCE 6X70
KIT2	1	6-01-008/R	1ST STAGE CYLINDER HEAD KIT
2.1	1		CYLINDER HEAD 1ST STAGE
2.2	1	6-01-009	CYLINDER HEAD GASKET
2.3	1	6-01-025	CYLINDER HEAD COVER GASKET
KIT3	1	6-01-001/R	1ST STAGE KIT
3.1	1		1ST STAGE CYLINDER 78MM DIAMETER
3.2	1		CYLINDER HEAD GASKET
3.3	1		O-RING 82,28X1.78 NBR 90SH
3.4	1		1ST STAGE PISTON KIT
KIT4	1	6-01-003/R	1ST STAGE PISTON KIT
4.1	1		1ST STAGE PISTON WITH RING SET
4.2	1	6-01-003/S	PISTON DIAM. 78 RING SET
4.3	1		1ST STAGE PISTON PIN
4.4	2		SEEGER
KIT5	1	SC000360	CARTRIDGE AIR INTAKE FILTER KIT
5.1	1	SC000345	CARTRIDGE AIR INTAKE FILTER

1ST STAGE

KIT5 - SC000360

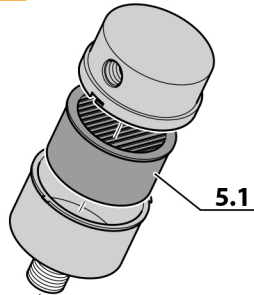

KIT2 - 6-01-008/R

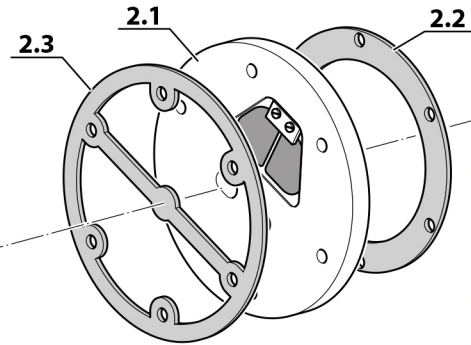

KIT1 - 6-01-015/R

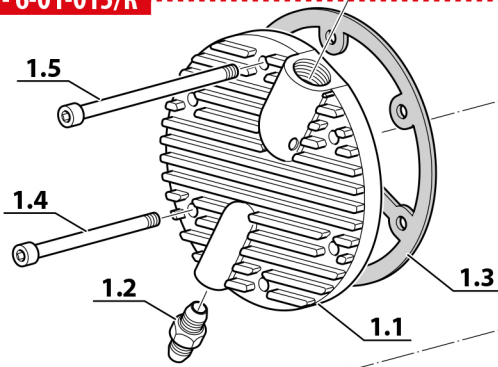

KIT4 - 6-01-003/R

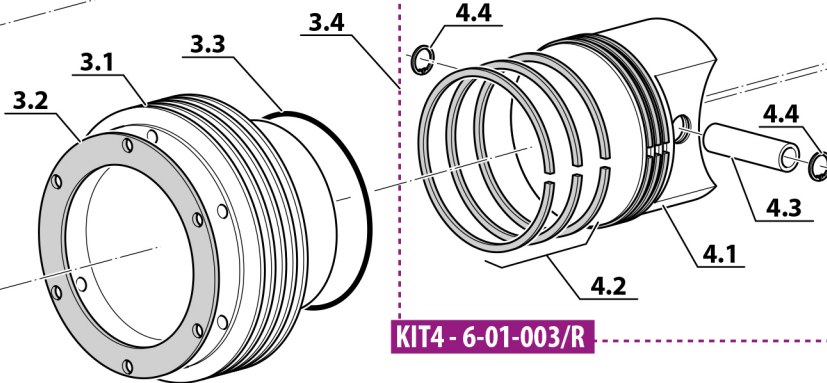

KIT3 - 6-01-001/R

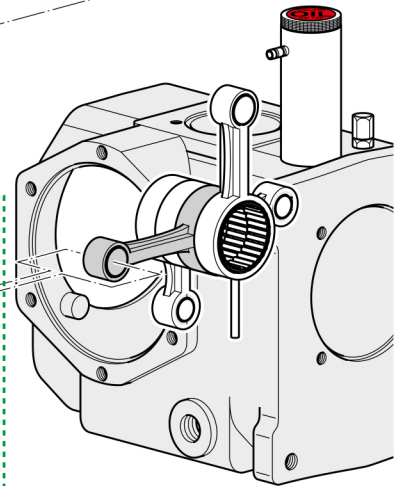
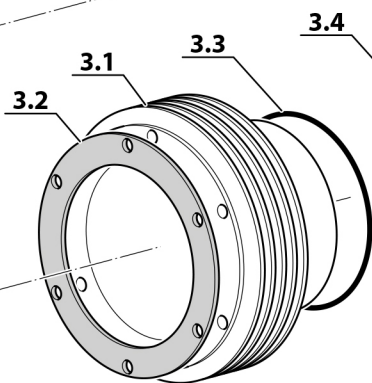

Direction of assembly of segments

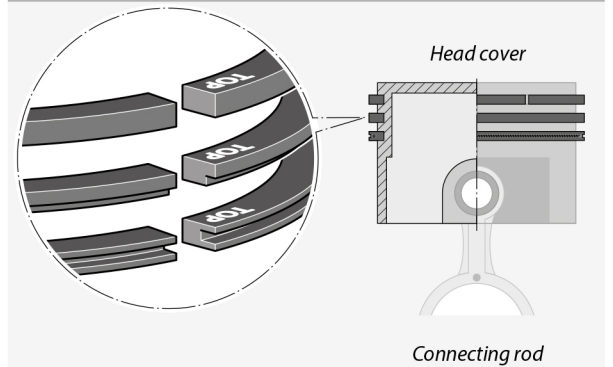

2ND STAGE

Pos.	Q.ty	Code	Description
KIT1	1	6-02-006/R	2ND STAGE CYLINDER HEAD KIT
1.1	1		CYLINDER HEAD 2ND STAGE
1.2	1		CONNECTION 1/8NPT - 8MM TUBE
1.3	4		SCREW T.C.E. ZINC. 6X60 DIN912
KIT2	1	6-02-008/R	2ND STAGE VALVE KIT
2.1	1		2ND STAGE VALVE BODY
2.2	1		COPPER WASHER 45X20X0.3
2.3	1		COPPER WASHER 51X40X0.3
2.4	1		SPRING
2.5	1		VALVE PLATE
KIT3	1	6-02-001/R	2ND STAGE CYLINDER KIT
3.1	1		2ND STAGE CYLINDER 38MM DIAMETER
3.2	1		O-RING 41X1.78 NBR 90SH
3.3	1		CONNECTION 1/8NPT - 10MM TUBE
3.4	1		2ND STAGE PISTON KIT
KIT4	1	6-02-003/R	2ND STAGE PISTON KIT
4.1	1		2ND STAGE PISTON
4.2	1	6-02-003/S	PISTON RING 2ST STAGE DIA38MM MCH/6
4.3	1		2ND STAGE PISTON PIN
4.4	2		SEEGER

2ND STAGE

KIT1 - 6-02-006/R

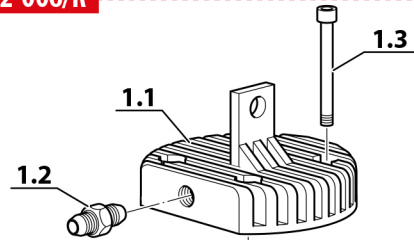

KIT2 - 6-02-008/R

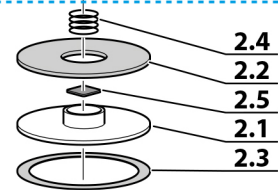

KIT3 - 6-02-001/R

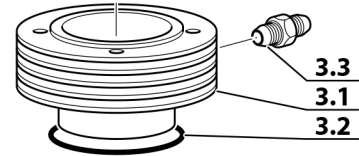

KIT4 - 6-02-003/R

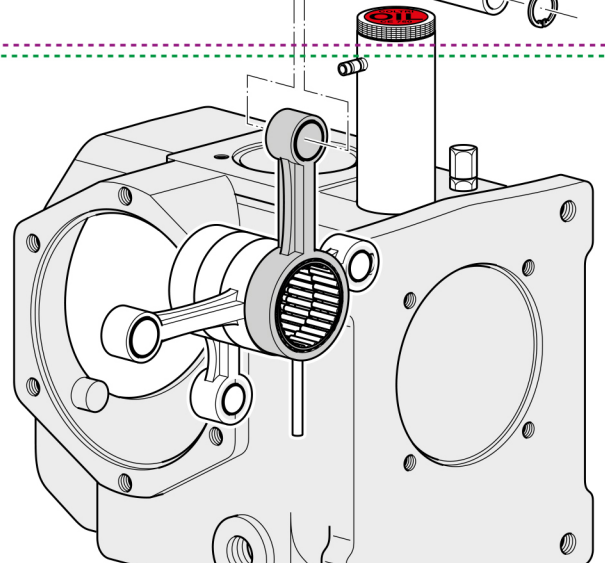
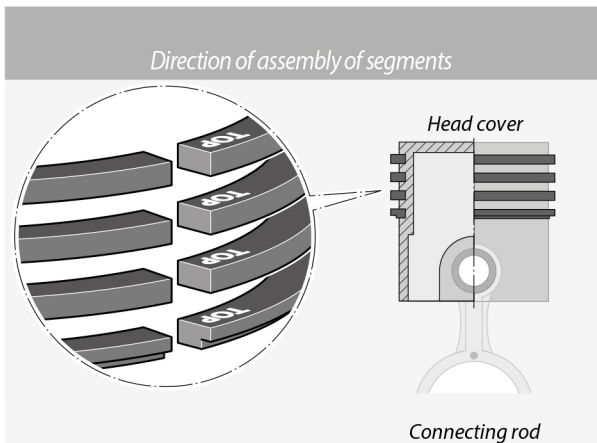
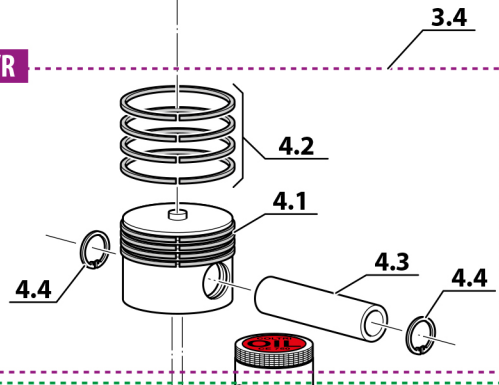

3RD STAGE

Pos.	Q.ty	Code	Description
KIT1	1	6-03-008/R	3RD STAGE CYLINDER HEAD KIT
1.1	1		CYLINDER HEAD 3RD STAGE
1.2	1		CONNECTION 1/8NPT - 8MM TUBE
1.3	4		SCREW T.C.E. ZINC. 6X55 DIN912
KIT2	1	6-03-007/R	3RD STAGE VALVE KIT
2.1	1		3RD STAGE VALVE BODY
2.2	1		COPPER WASHER
2.3	1		SPRING
2.4	1		VALVE PLATE
KIT3	1	6-03-001/R	3RD STAGE CYLINDER KIT
3.1	1		3RD STAGE CYLINDER (*)
3.2	1		O-RING 23.52X1.78 NBR 90SH
3.3	1		CONNECTION 1/8NPT - 8MM TUBE
3.4	1		3RD STAGE PISTON (*)
3.5	1		PISTON RING SET
3.6	1		PISTON RING
3.7	1		RETAINING PIN 3RD STAGE 7X17
4	1	6-05-121	3RD STAGE SAFETY VALVE MCH-6

3RD STAGE

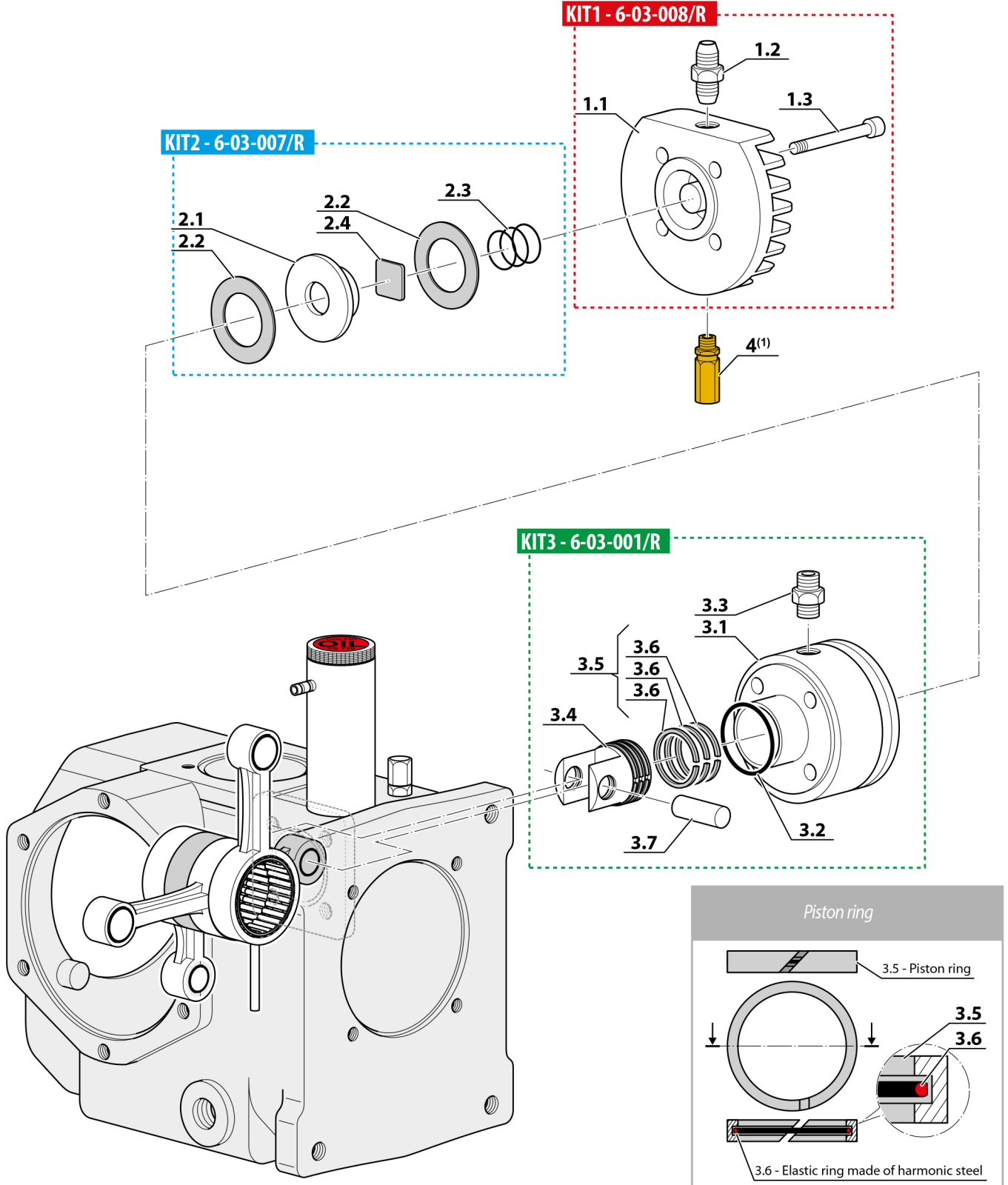

4TH STAGE

Pos.	Q.ty	Code	Description
KIT1	1	6-04-003/R	4TH STAGE CYLINDER KIT
1.1	1		4TH STAGE CYLINDER (*)
1.2	1		4TH STAGE PISTON (*)
1.3	1		RETAINING PIN 3RD STAGE 7X22
1.4	1		RING J7
1.5	1		CONNECTION 1/8NPT - 8MM TUBE
1.6	1		O-RING 26.7X1.78 NBR 90SH
1.7	4		SCREW TCE 6X25 ZINC
KIT2	1	6-04-007/R	4TH STAGE CYLINDER HEAD KIT
2.1	1		4TH STAGE CYLINDER HEAD
2.2	1		COPPER WASHER 18X26X1.5
2.3	1		SPRING
2.4	1		VALVE PLATE

4TH STAGE

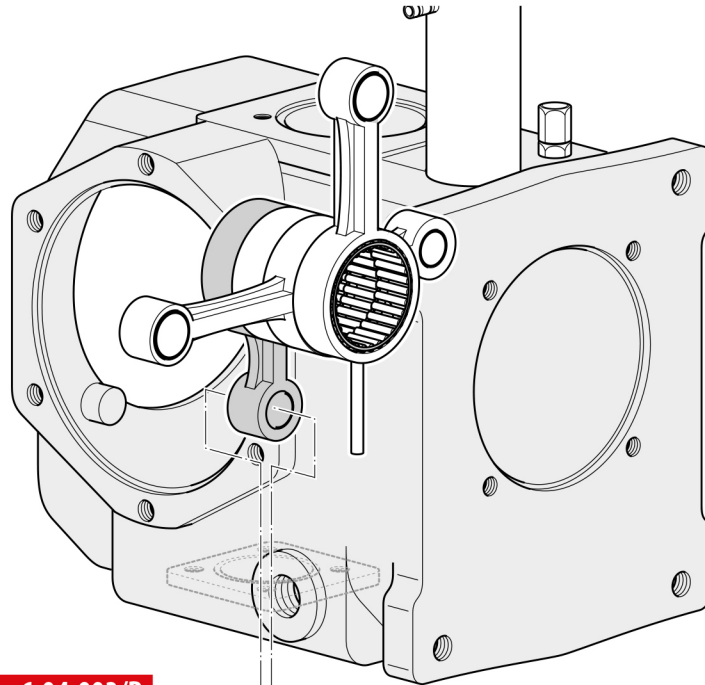

KIT1 - 6-04-003/R

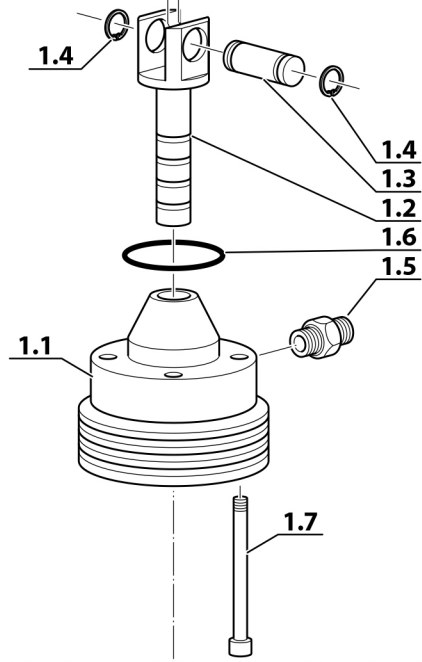

KIT2 - 6-04-007/R

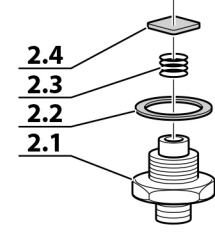

PRESSURE CIRCUIT

Pos.	Q.ty	Code	Description
KIT1	1	13-00-0135/R	RETAINING PIN Ø6 KIT
1.1	1		ANTI VIBRATION BLOCK
1.2	1		RETAINING PIN 6MM
1.3	1		SCREW TCE 5X25 ZINC
1.4	1		SELF-LOCKING NUT M5
1.5	1		ZINC WASHER M5
2	1	6-01-019/R (*)	TUBE Ø10 INOX 1st STAGE - 2nd STAGE
3	1	6-02-014A/R (*)	TUBE Ø8 INOX 2nd STAGE - 3rd STAGE
4	1	6-02-014/R (*)	TUBE Ø8 INOX 3rd STAGE - 4th STAGE
5	1	6-05-013E/R (*)	TUBE Ø6 INOX 4th STAGE - CONDENSATE SEPARATOR
6	1	6-05-007E/R (*)	TUBE Ø6 INOX CONDENSATE SEPARATOR - FILTER

PRESSURE CIRCUIT

KIT1 - 13-00-0135/R

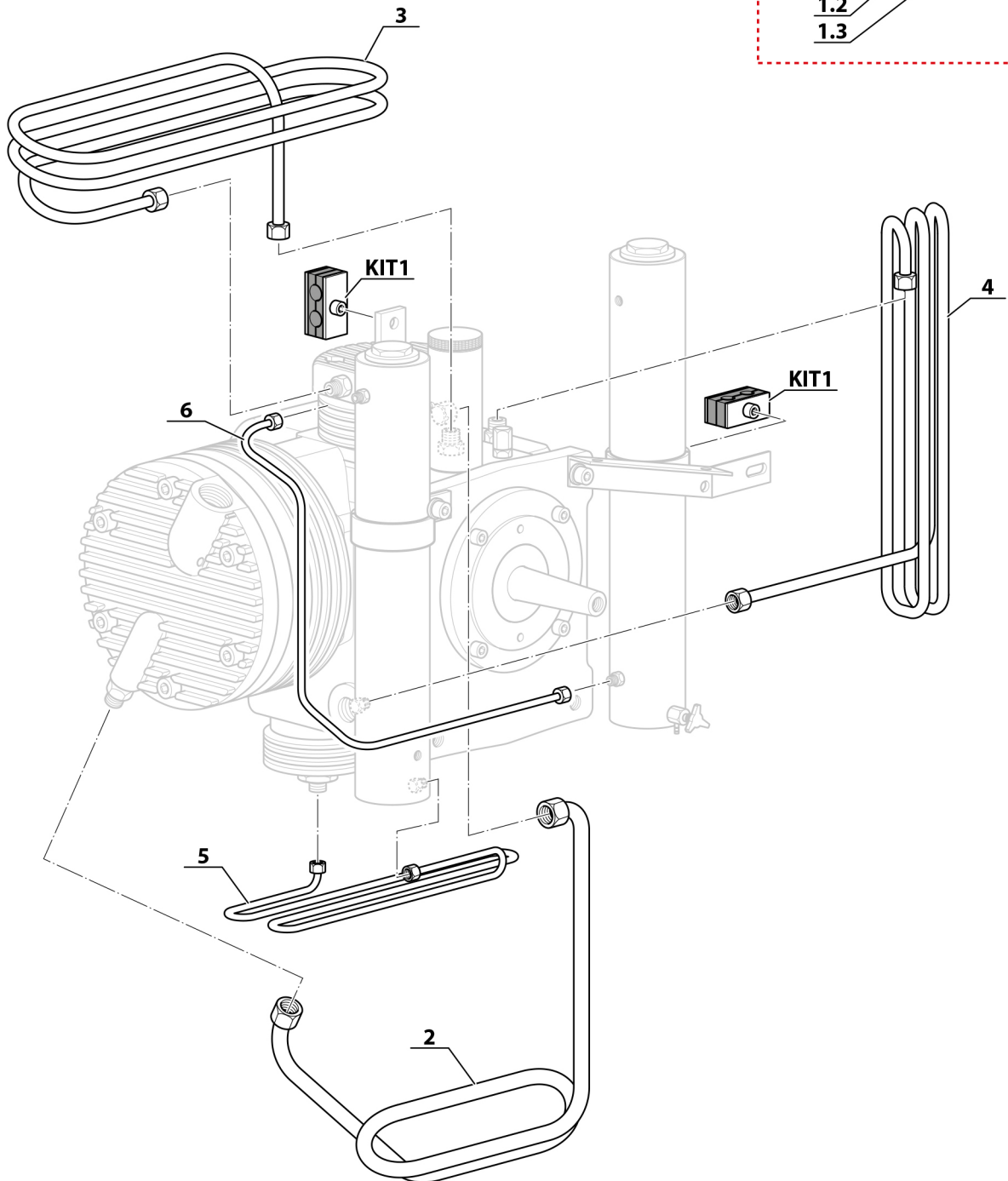
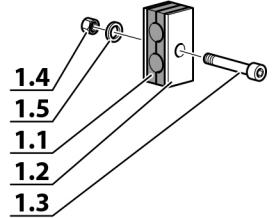

GASKETS PUMPING GROUP

Pos.	Q.ty	Code	Description
1	10	OR-2300/R	KIT WITH 10 OR 2300 NBR 90 SH
2	10	OR-2093/R	KIT WITH 10 OR 23,52X1,78 NBR 90 SH
3	10	OR-4081/R	KIT WITH 10 OR 20,22X3,53 NBR 90 SH
4	10	OR-2250/R	KIT WITH 10 OR 2250 NBR 90 SH
5	10	OR-4112/R	KIT WITH 10 O-RING 4112 NBR 90 SH (28,17X3,53)
6	10	OR-2018/90/R	KIT WITH 10 O-RING 2018 NBR 90 SH (4,48X1,78)
7	10	OR-114/90/R	KIT WITH 10 O-RING 114 NBR 90 SH
8	10	OR-2106/R	KIT WITH 10 OR 26,7X1,78 NBR 90 SH
9	10	OR-2325/R	KIT WITH 10 OR 82,28X1,78 NBR 90 SH
10	10	OR-2162/R	KIT WITH 10 OR 41X1,78 NBR 90 SH
11	10	6-02-004/R	KIT WITH 10 UPPER COPPER GASKET 45X20X0,3
12	10	6-02-007/R	KIT WITH 10 LOWER COPPER GASKET 51X40X0,3
13	10	6-03-009/R	KIT WITH 10 COPPER GASKET
14	10	6-04-008/R	KIT WITH 10 COPPER GASKET 18X26X1,5
15	1	6-01-009	HEAD GASKET
16	1	6-01-025	COVER GASKET

GASKETS PUMPING GROUP

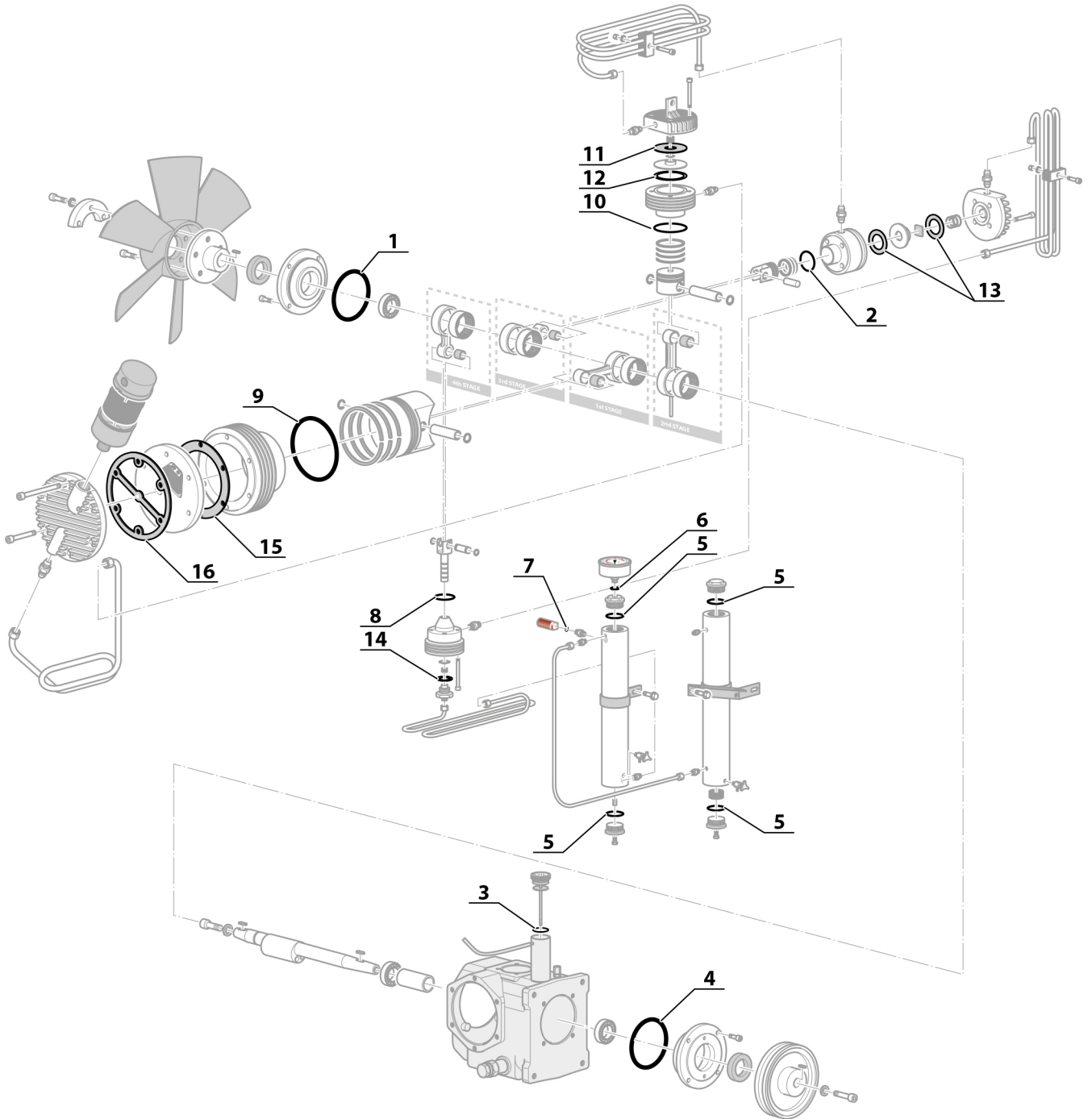

- | | | | | | | | | | | | | | | | |
|-----------|-----------|-----------|-----------|-----------|-----------|-----------|-----------|-----------|-----------|-----------|-----------|-----------|-----------|-----------|-----------|
| 1 | 9 | 4 | 2 | 3 | 5 | 8 | 10 | 6 | 7 | 11 | 12 | 13 | 14 | | |
| 10 O-RING | 10 O-RING | 10 O-RING | 10 O-RING | 10 O-RING | 10 O-RING | 10 O-RING | 10 O-RING | 10 O-RING | 10 O-RING | 10 O-RING | 10 O-RING | 10 PIECES | 10 PIECES | 10 PIECES | 10 PIECES |

DESCRIPTION

PUMPING UNIT

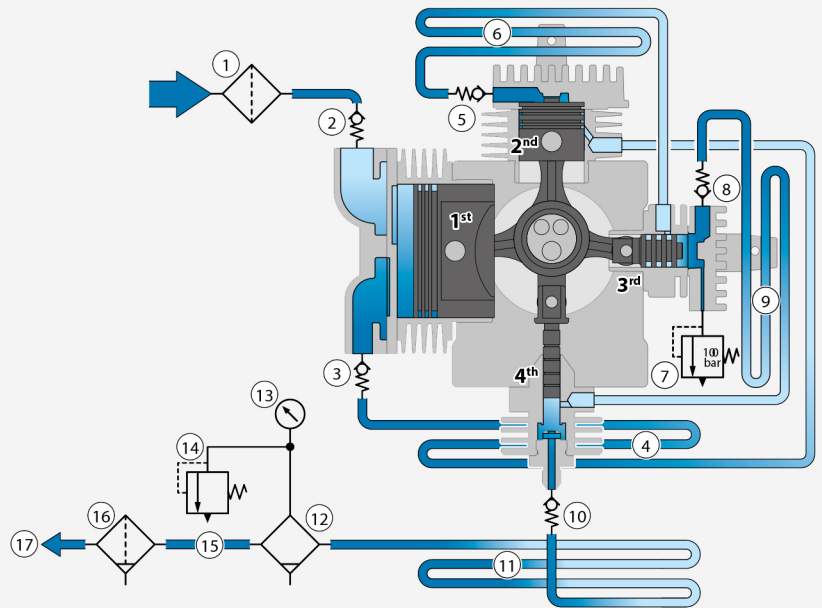
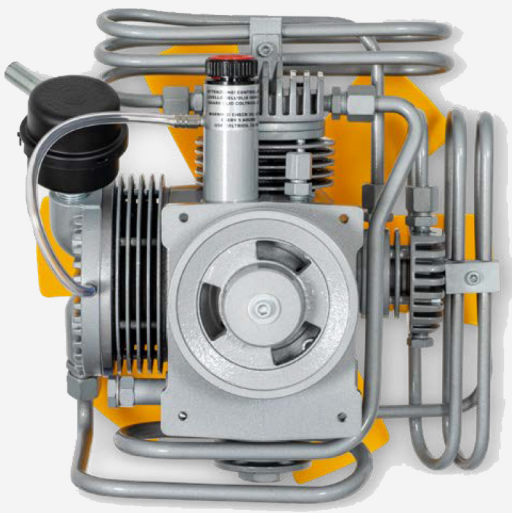

- | | |
|-------------------------------------|---|
| 1 Intake filter | 10 Outlet valve 4th stage |
| 2 Intake valve 1st stage | 11 Final cooling pipe |
| 3 Outlet valve 1st stage | 12 Condensate separator |
| 4 Cooling pipe 1st-2nd stage | 13 Pressure gauge |
| 5 Outlet valve 2nd stage | 14 Safety valve |
| 6 Cooling pipe 2nd-3rd stage | 15 Cooling pipe separator / filter |
| 7 Safety valve | 16 Purifier filter |
| 8 Outlet valve 3rd stage | 17 Flex hose |
| 9 Cooling pipe 3rd-4th stage | |

DIMENSIONS

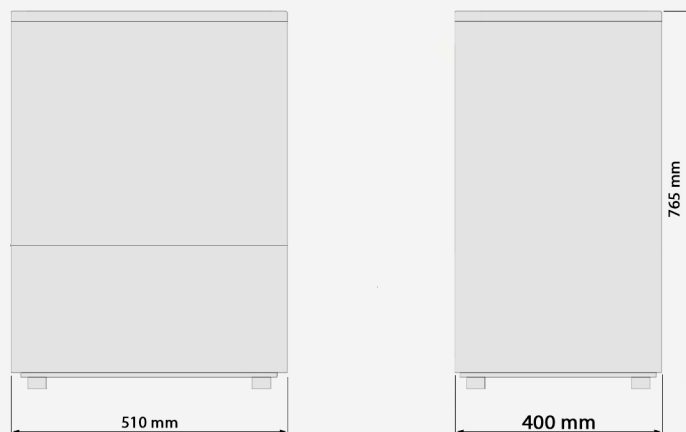

MACHINE PARTS

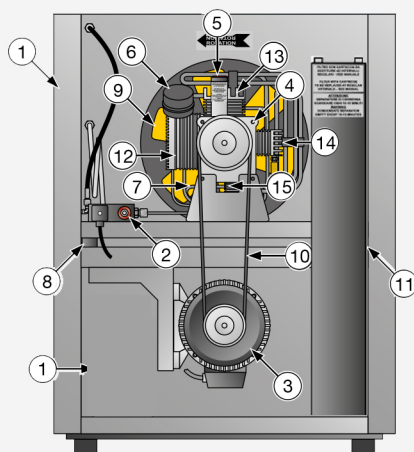

-
- | | |
|---------------------------------|---------------------------|
| 1 Frame | 11 Purifier filter |
| 2 Safety valve | 12 1st Stage |
| 3 Engine | 13 2nd Stage |
| 4 Compressor | 14 3rd Stage |
| 5 Oil filler cap | 15 4th Stage |
| 6 Air filter | |
| 7 Oil discharge plug | |
| 8 Anti-vibration devices | |
| 9 Cooling fan | |
| 10 Belt | |